

COMPO SHOPPING CENTER

397 POST ROAD EAST | WESTPORT, CT 06880



PROPERTY INFORMATION:

- GLA 47,000sf
- High Income
- High visibility and good access. Shares traffic light with Trader Joe's
- Extremely busy Post Road. 23,000 Vehicles per day
- Join extremely successful CVS
- Traffic controlled access

AREA DEMOGRAPHICS:

RADIUS	POPULATION 2015	MEDIAN HH INCOME	AVERAGE HH INCOME
3 mile	40,719	\$147,244	\$226,094
5 mile	120,588	\$123,311	\$172,953
7 mile	202,419	\$125,759	\$172,585

FOR MORE INFORMATION CONTACT:

DAN ZELSON | 203.227.2922 | dan@chartweb.com

ANCHORED BY:



SPACE DETAILS:

- Available 1,100sf - 5,200sf

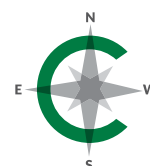

CHARTER
REALTY & DEVELOPMENT

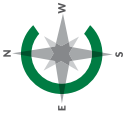
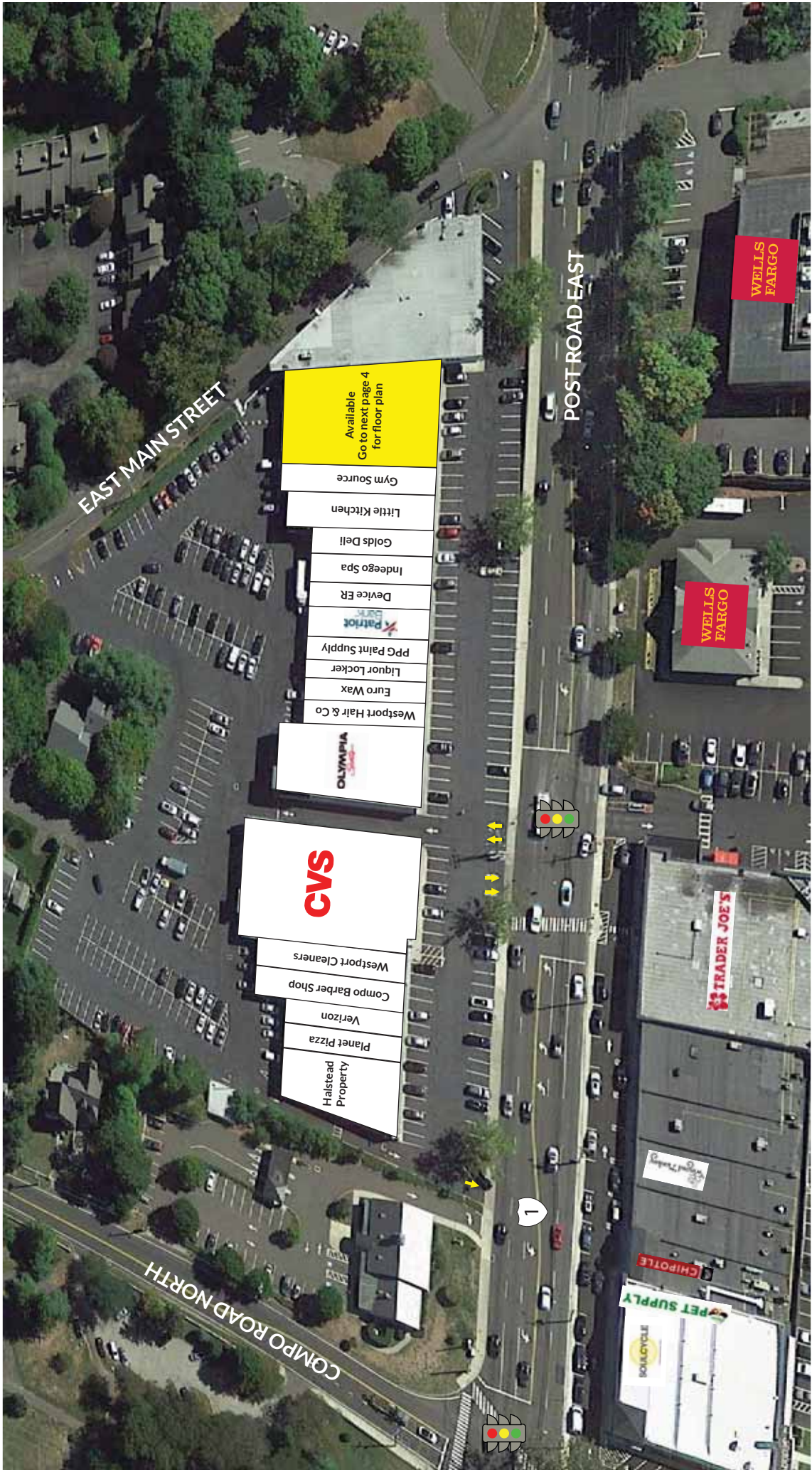

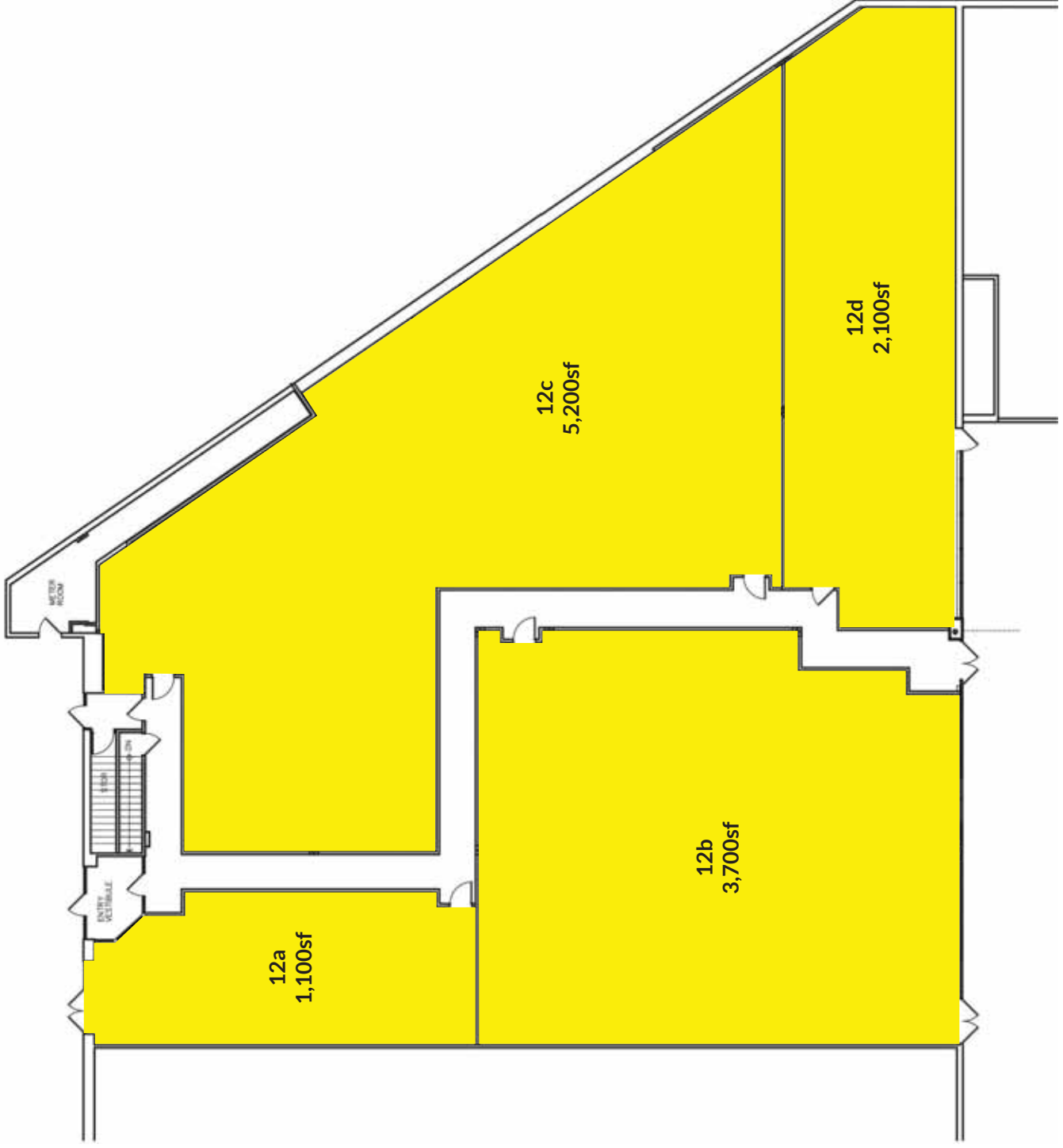

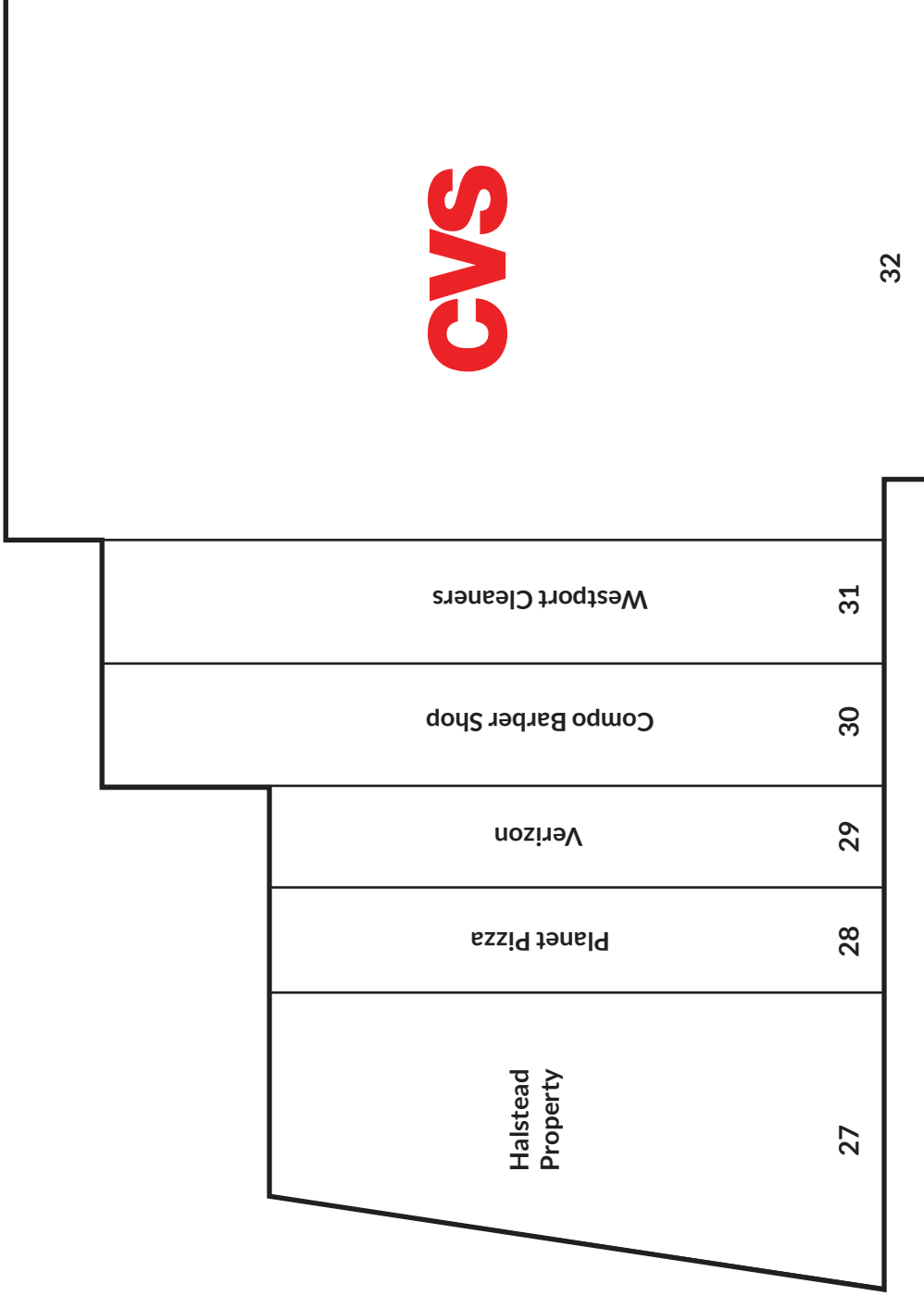



CHARTER REALTY & DEVELOPMENT
Information contained in this document has been reviewed and approved by Charter Realty and Development; however, errors sometimes occur. Charter disclaims any warranty of any kind, expressed or implied, as to any matter whatsoever relating to this service. In no event shall Charter be liable for any indirect, special, incidental or consequential damages arising out of any use of or reliance on any content or materials contained herein.

