

**Indicated layout of structural members is approximate and will need to be field verified**

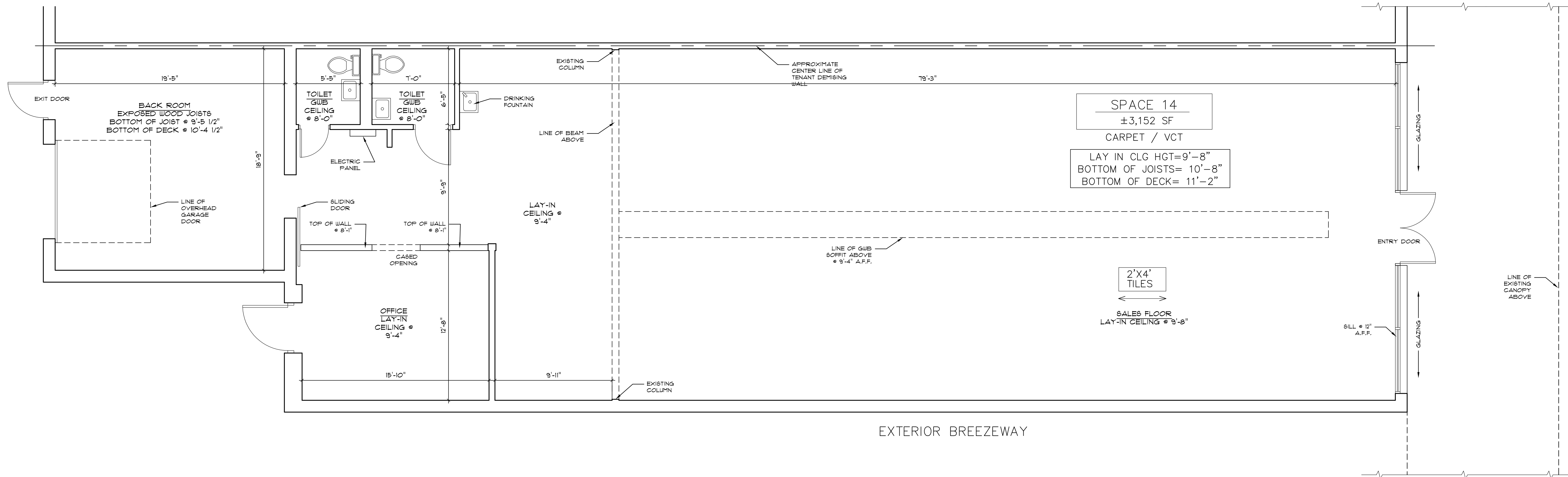

**SPACE #14, GROTON MALL**

**684 Long Hill Rd.  
Groton, CT 06340**

**WP REALTY, Inc.**

940 HAVERFORD ROAD  
BRYNMAWR, PA 19010  
TEL. 610.552.6000  
FAX 610.552.6001

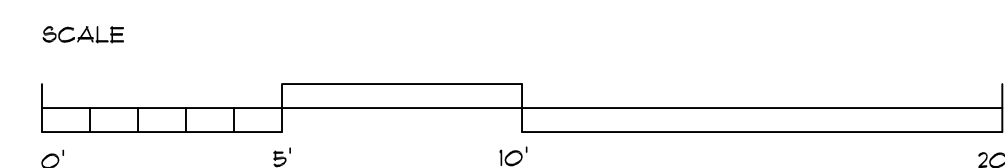
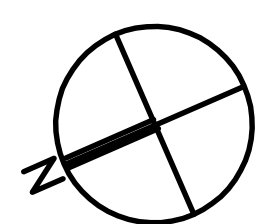

SCALE : 1/4" = 1'-0"