

# Haverford Road

600 Haverford Road - Haverford, PA 19041



**CHARTER REALTY & DEVELOPMENT CORP.**

Building Value Through Relationships



Ground Floor

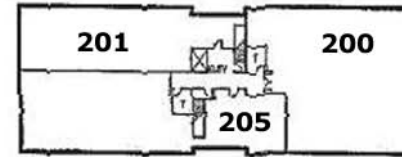

Second Floor

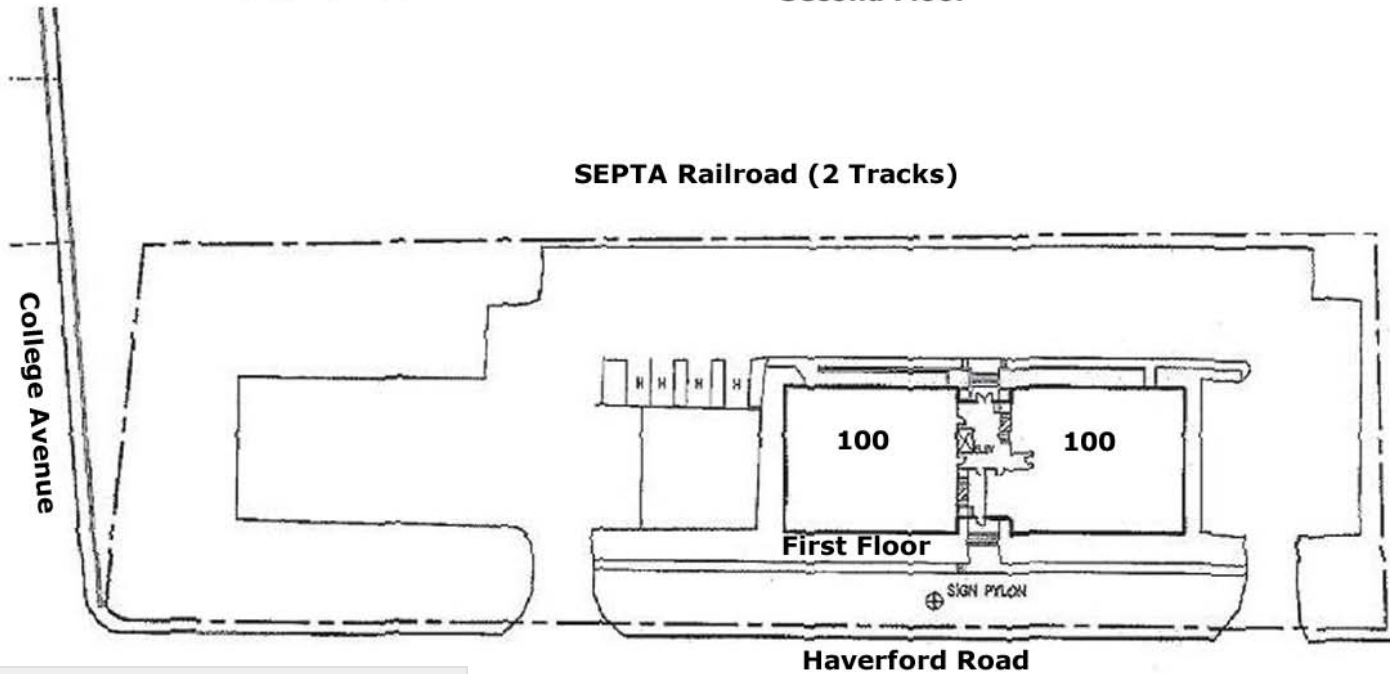

SUITE	TENANT	SQUARE FEET
100	Kids First	7,700
200	<b>Available</b>	<b>1,637</b>
201	<b>Available</b>	<b>2,200</b>
202	Learning Rx Main Line	1,500
205	Bullock-Klinzing PC	2,458
G100	Ernest Barbieri DDS	1,587
<b>G101</b>	<b>Available</b>	<b>1,650</b>
G103	Marc Baer DPM LLC	1,750
G104-1	Anna Lipshutz MSS LCSW	286
G104-2	Valerie Huff	275
G104-3	Johanna Levitt	275
G104-4	Janet Siegel	278
G104-5	Innobenefits LLC	342

**FOR MORE INFORMATION CONTACT:**

**DANIEL MORTIMER**

940 Haverford Road  
Bryn Mawr, PA 19010

Phone: 484 419 1192

Email: [dmortimer@chartweb.com](mailto:dmortimer@chartweb.com)

Website: [www.chartweb.com](http://www.chartweb.com)

# Haverford Road

600 Haverford Road - Haverford, PA 19041



**CHARTER REALTY &  
DEVELOPMENT CORP.**

Building Value Through Relationships

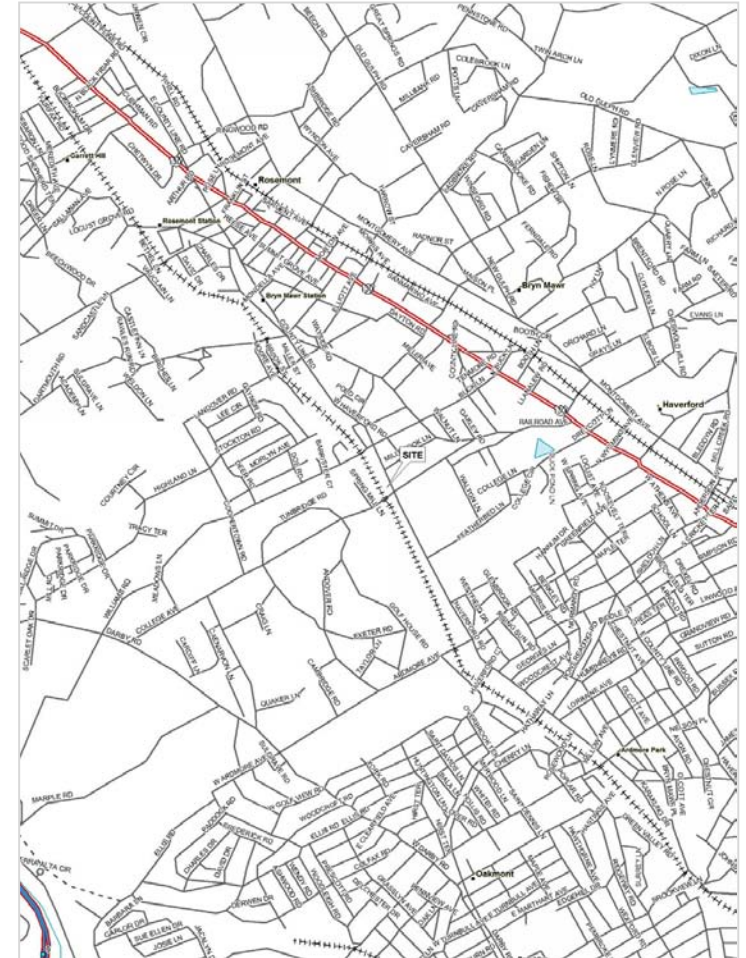

## PROPERTY INFORMATION

- GLA 21,938 sf

## FOR MORE INFORMATION CONTACT:

**DANIEL MORTIMER**

940 Haverford Road

Bryn Mawr, PA 19010

Phone: 484 419 1192

Email: [dmortimer@chartweb.com](mailto:dmortimer@chartweb.com)

Website: [www.chartweb.com](http://www.chartweb.com)